



WOODTURNERS OF ST. LOUIS

A Chapter of the American Association of Woodturners

stlturners.org

August 2013

July Demo > Jon Spelbring – Turning a Kendama



Jon demonstrated the Kendama tricks and the turning of the ball, the cups, and the stick parts of a Kendama. There are several techniques that can be used in turning a sphere. Some can be found on our club web projects page. It was also demonstrated in the August pre-meeting and is covered in that section of this newsletter. We'll pick up Jon's demo with the cups and stick parts.



Once you have your sphere you are ready to turn the cups. If your sphere is per specs you can turn the parts in any order you want but if it is not quite to spec then you need your sphere to check the cups. First drill a 3/8" hole through the center of the cup block and then mount it in a chuck. The ends of the cup block should have the diameters marked (check the drawings as one end has a larger diameter hole). As you make the cup shape, take the ball or a template and test it with the cup to make sure the sphere does not bottom out. Flip the cup block over and turn a cup in the other end to the correct diameter/depth. You are now ready to turn the profile between the cups. The stock is held in place with two bungs that have a shape to match the cups you just cut.



Jon has a OneWay live center with a threaded end piece. He removes the end piece, turns a bung in a piece of scrap material and then cut threads in the center of it. The bung can then be threaded on the OneWay live center. (Editor's note: if your live center has a rotating head make the block of wood slide over the entire rotating part. See the pre-meeting demo for pictures.) A corresponding bung with a dome to match the cup is put in the head stock chuck.

The profile between cups should match the diameter of your sphere. Use your template or sphere to check as you turn.



You are now ready to turn the final piece, the stick. Leave a little extra on the end to account for the hole left by the live center. Draw the end cup on the piece and mount it in a chuck (Editor's note: Gripping a piece of square stock is not very secure especially when you are not using the tail stock. It may be better to round the block so that you get a good grip from the chuck.) Hollow out the end for the cup and test fit with the sphere. Flip ends and you are ready to turn the profile of the stick.

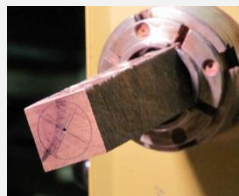

Mark the location of the profile changes and turn down to the specified diameters. A piece of scrap can be chucked in the head stock, a 3/8" drilled in it and used as a jam chuck along with a bung in the tail stock to do the final finishing.



See the AAW article on the club web site for assembly instructions.



Pre-Meeting Demo> Charles Sapp – Turning a Sphere for the Kendama●



If you can cut in a straight line then you can make a sphere. You just have to do it several times. Charlie demonstrated the Al Hockenbery approach for turning a sphere. The most common problem is making a cut that is below the desired surface of the sphere. When that happens there are only two solutions – throw it away and start over or be satisfied with a smaller sphere.

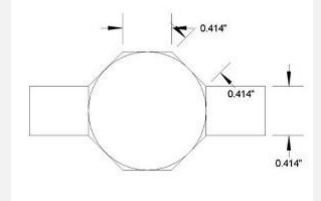

The principle is to first cut an octagon shape around the sphere. Then split those surfaces so that you have a 16 sided figure. This is typically close enough to a sphere that minor shaping will produce a good product. The geometry works out such that the octagon that surrounds the sphere has 8 faces with a chord length of $.414 \times \text{Diameter of the sphere}$.

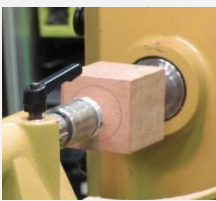

Start with square stock that is about 1" longer than it is square. Find the centers and mount it on the lathe. Turning with a steb center is very forgiving for catches. Once the stock is turned into a cylinder with a diameter equal to that of the sphere (plus sanding material or ~61mm) the sphere diameter and center are marked on the cylinder. The centerline is on the surface of the sphere and will not be turned away. Next mark $.207 \times \text{Diameter}$ on both sides of the center line (12.6mm). The distance from both of those marks is $.414 \times D$ or one of the octagon faces (top and bottom face in the figure above).



Then part in at the ends of the sphere/cylinder to create a tenon that is $.414 \times \text{Diameter}$ on both ends. Making a series of straight cuts from each of the lines marked on the cylinder to the tenon on each end will produce a shape with 8 sides each with a chord of $.414 \times D$ to give our initial octagon shape. Then mark a line on the center of each flat you just cut (dark pencil lines). The lines on each of the new flats and the centerline are on the surface of the sphere and are not to be cut away.

You then part in about half-way on the tenons at the end of the sphere (see picture to the right) and mark the centers between the lines on the surface of the sphere (the dark pencil lines) and the corners where the flats meet. See the red lines on the picture. Then cut in a straight line between the new red marks to establish flats and you have a 16 sided shape. Continue to part off the tenons or cut them off with a saw.



The rough sphere is then mounted between centers using cup chucks and light cuts are taken to remove the shadow that indicates high points on the piece. After about 3 to 4 rotations of the axis and light shaping, the surface will be approaching a sphere. A ring can be used to check for high spots.



The next step is to drill a ½" diameter hole in the sphere. The sphere can be held in a doughnut jig or a jam chuck as shown. Knowing the diameter of the sphere the drill bit can be marked with tape such that you leave ~1/8" of material. If you have a long 1/8" bit you can then finish drilling the hole for the string. Turn a ¾" chamfer on the hole before removing the sphere.



If you use your drill press for the 1/8" hole, ensure it is in the center of the ½" hole. Secure a board to the drill press table, drill a ½" hole, plug it with a short section of dowel rod, and place the ball over the dowel. Then drill the final 1/8" hole. This will align the two holes.



For other approaches on turning a sphere see [projects](#) on the club web site and check these links: <http://aaw.hockenbery.net/SphereDescription.pdf>, <http://aaw.hockenbery.net/turning%20the%20ball.pdf>, <http://www.woodturner.org/community/youth/projects/Sphere.pdf>.

Library News > Rich Hinkebein● Last month the following items were added:



- American Woodturner magazine – includes some good tips and an article on a novel way to do segmented turning.
- Diamond Sharpening DVD donated by a club member. It has good information on using a variety of diamond stones for sharpening a variety of tools quickly.
- The Encyclopedia of Wood published in 2007 by the USDA and donated by a club member covers a wide variety of information on wood and its use.
- At the recent AAW symposium the organization had packaged two groups of publications at a discounted price. Thanks to Dan Schmoker for bringing back the set of 4 titled, "Getting Started in Woodturning" for our club to purchase; the club also purchased the second group. Each is a set of 16-18 articles taken from the American Woodturner magazine.
 - The first group is: Lathes and Turning Tools; Safety for Woodturners; Practical Woodturning Projects; and Learning at the Lathe.
 - The second group added to our library is: AAW Project and Techniques Book 1987-1992; 1993-1995; 1996-1998; 1999-2001; and 2002-2004. Each contains a large number of interesting projects. The index for each book of the second group can be found on the AAW website (<http://www.woodturner.org/Shop/ProductShopItem.asp?PID=182>)
- An index of our club library is now available on the [club website](#).
- The library will be open at the picnic for returns and DVD checkout!

Our library is only open on Sunday at our club meetings and is open to all our members for checking out books, videos, and DVD's.

When checking out material, sign/date the card and put it BEHIND the letter of your last name in the box. When you return material make sure you put the card back in the item and that the card goes with that item. Watch that you do not put multiple cards in one item. And please sign legibly so you can be tracked down if something is amiss.

Our library is a great source of inspiration and knowledge. Please take advantage of this wonderful club benefit.



President's Spin > Jon Spelbring • Ok, who got the seasons mixed up? We had a cool summer, and I can live with that, but what's with the upper nineties this close to Labor Day? I hope the temps cool a little before the picnic. Speaking of the picnic, I hope that everyone is diligently working on their Kendamas. I hope that despite my demo, you have the information and techniques you need. There will be several prizes (gift certificates) for the Kendama contests:

- most successive catches (any cup)
- most successive spike catches
- most flip catches (back and forth between the side cups)
- all three cups, in order (largest to smallest)
- same as above, but finish with a spike catch

Website news: more of our old newsletters are coming online - primarily thanks to our fearless Secretary and newsletter editor, Charlie. I'm also working on getting some of our old pictures up - especially our collaborative projects. Also a reminder: if you would like your work featured on the front page, just send me a note, along with 4 pictures - 640x480. I would also ask that the pictures be "good". By that, I mean well composed, lit, and preferably with a neutral background. I would also discourage the temptation to add on an object for size comparison. Just tell me the dimensions of the piece(s) in the email, and I'll add them to the image.

Laura passes on her thanks to all who brought in vases - they are going to look beautiful on the tables.

I'd also like to thank Chris for taking up videographer duties - excellent job!

That's it for now. See you at the picnic. -Jon

Tip of the Month> For forms that are glued together, turned, split and reglued with a 90° rotation – rotate the grain when you first glue up the item. Then when it is rotated after turning, the grains will align. – Dixi Smith

Club News>

Scholarships / Training• The AAW offers scholarships/grants for training. For 2013 the AAW Education Opportunity Grants (EOG) had 117 applications and 27 were approved in the amount of \$35,723. Applications must be submitted by December 31 annually. Contact any of the officers if you would volunteer to write an application for our club. <https://www.woodturner.org/resources/eog/>.

In addition, the AAW Board of Directors announced a new scholarship initiative. In recognition of the invaluable contributions made by our local chapters to our educational mission, twenty-seven scholarships to

two of the nation's leading woodturning centers will be provided in 2014 to members of the American Association of Woodturners. Under the program, the AAW Endowment Trust Fund (ETF) and the Arrowmont School of Arts and Crafts will make available funds for 14 \$550 scholarships at Arrowmont School of Arts and Crafts. In addition, the ETF, working with John C. Campbell Folk School will award 13 \$594 scholarships. Altogether, 27 scholarships will be awarded. In total, \$15,422 in scholarships will be given to AAW members. Our chapter will be allotted one nomination.

If chosen by the AAW, the member submitted by our club for the scholarship must agree to host a demonstration for the club within 6 months of the training on the subject matter from Arrowmont or JC Campbell. If you are interested in being considered, contact President Jon Spelbring (in writing/email) stating that you agree to the terms.

The program is to provide tuition only. Any room and board and travel to the school locations will remain the responsibility of the nominee. John C. Campbell Folk School is located in Brasstown, NC; Arrowmont is in Gatlinburg, TN. *All classes will take place in 2014.*

Membership dues are due● Dues for 2013 became payable at the end of last year. An [application](#) is available on the club web site. Dues are \$30 individual; \$40 family. If you are renewing, please make sure that the [contact information](#) we have on file is correct.

Attendance/Treasurers Report● Thirty six members/guests attended the August meeting.

Web site● The new site is open: www.stlturners.org and development continues. The Kendama article from AAW is available under the projects tab and an index for the club library has been added. If you have any issues logging onto the site or becoming a registered member, contact [Jon Spelbring](#) or [Brandon Harris](#). If they do not respond within 48 hours, please contact them again via email.

Each member can load pictures to their profile. If you would like to be featured on the home page, provide Jon with 4 to 6 good quality pictures (640 x 480) of your turnings with the same background.

We are in the process of taking over the old URL so www.stlturners.org will continue to be our official URL.

Thanks to Charles York for providing some of the older newsletters that have been uploaded. If you have any paper copies of issues that are missing from our web site, please contact Charlie Sapp. He will scan them and return them to you.

Safety Shield & Videographer Assistance Needed● Thanks to those that helped in getting the safety shield and video equipment set up prior to the meeting and put away. This will be needed at all the Woodcraft meetings so please continue to help with the set up and put away. Thanks to Chris Weiler for a great job with the video of both the pre and meeting demos.



Picnic Planning● September 29 is the date for our club picnic. Note that it is on the 5th Sunday versus the 4th Sunday of the month and will be at Spencer Creek Park, 200 Sutters Mill Road, St. Peters. A map to the picnic can be found at: <http://goo.gl/maps/p8rWT>. Bring a side dish to share. Lunch will start at 1 pm. The club will be providing paper products, utensils, coffee, and the meat. Jeff Bemis will be bringing his green smoker to cook the meat. You are responsible for your drinks if you want something other than coffee.



The challenge for the picnic is to turn a Kendama – and then perform tricks with it. Prizes will be awarded. For more information: www.kendamakyokai.com/index_english.html , <http://sweetskendamas.com/videos/tips-tricks/> or the video at http://search.yahoo.com/search;_ylt=Aowzo16aQbVhztYb45uZy6ubvZx4?fr=yfp-t-900-1-s&toggl=1&cop=mss&ei=UTF-8&p=kendama%20tricks.



We will also have the creative event where everyone can assemble “whatever” from scrap wood pieces using hot glue and imagination. (Members, save those ends and cut offs and bring them to the picnic for this event.) There will also be the swap and sell table where you can trade or sell wood, tools, finishes, Laura will be providing flower arrangements for the tables using the vases provided by club members.

Coffee and Cookies● Complementary coffee is available at the meetings. Cookies are 50 cents each and purchased on the honor system.



President’s Challenge> August Turn Thin● The President’s Challenge for August was to turn “thin”. The winning entry, selected by the members, was this thin wall bowl by Dixi Smith. Comments were made that “you can see light through the walls”.



Congratulations to Dixi. The other entries in the President’s Challenge are shown in the President’s Challenge section of the newsletter.

September Presidents Challenge - Kendama● Turn a Kendama for the picnic. Entries will be judged by the members. A gift certificate will be awarded the winning turning and all entrants will get credit toward the year end drawing (minimum of 6 entries during the year).

Nomination of Board Members for 2014● If you are interested in serving the club as a Board Member, please contact any of the current officers. Jon is currently serving the second of his two year terms and we will need a member to step forward to serve as President. The other positions will also be up for election.

Professional Turner Seminar● The club has scheduled [Nick Agar](#) for a seminar and hands on turning event on 12-14 April 2014. The hands on turning will be at Woodcraft. Cost and sign up will be available soon.

Club Membership Roster● A copy of the current club roster is attached to the snail mail distribution of this newsletter. Members with electronic access can view the [roster](#) on-line.

Symposiums>

● [Rocky Mountain Woodturning Symposium](#): The 15th annual symposium will be held Sept 13-15, 2013 at The Ranch/Larimer County Fair Grounds in Loveland, Colorado. Featured turners will include David Ellsworth, Binh Pho, Trent Bosch, and [Michael Blankenship](#). YES, our Michael Blankenship will be demonstrating “Turning Blind – Three Piece Hollow Christmas Ornament”. Congratulations to Michael on this significant accomplishment and recognition of his turning abilities.

American Association of Woodturners● The AAW is dedicated to providing education, information, and organization to those interested in woodturning. You can join the AAW at their site: <http://woodturner.org/member/MemberLogOn.asp>. Membership comes with access to on-line training information and includes a subscription to the *American Woodturner* magazine. Our club is a chapter of the AAW.

Remember to vote for your 2014 AAW Board of Directors. Voting must be completed by Oct 18, 2013.

Upcoming Events:

Coming Events Calendar		
Sept 29	Annual Picnic	Meeting will be held at Spencer Creek park. Challenge – bring your Kendama for judging and competition. Turn a vase for table decoration! See article in the newsletter for more information.
Oct 27	Meeting at Woodcraft	TBD
Nov 24	Meeting at Woodcraft	Annual Wine & Cheese Social, Ornament exchange, Officer Election. No pre-meeting or meeting demo. Bring an appetizer and drink to share.

Member Interests● The Board needs your feedback/input on demonstrations for next year. What would you like to see turned – functional items (rollings pins, salt shakers, bowls, tools,..) or would you like to create art (wall decorations, jewelry, air brushing, surface decorating,..) or would you like to see pens (wood, plastic, nuts, ...). WE NEED YOUR FEEDBACK to better serve you. Please send an email to [Charlie](#) or contact any of the officers with your thoughts.

August Show and Tell



Walt Ahlgrim turned a marudai for his wife to braid kumihimo cords. [Kumihimo](#) is a Japanese form of braiding strands of silk to create intricate colored cords. Samurai once used kumihimo as laces for their armor.



Jeff Bemis turned these bottle stoppers from Corian that he glued up.

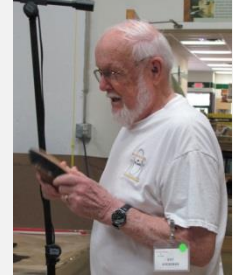

Ray Koeneman showed a piece that was finished with [liming wax](#). It turns the pores white but be aware that it reacts differently depending on the type of wood.



Beaded platters turned by Rick Madden. The lower photo shows the parts before they were assembled. Rick also turned this vessel from oak, dyed it black and then accented the growth lines with white shoe polish paste. The finial is made from holly. Rick has a tutorial on making the spiral/twisted finial on the [Sawmill Creek web site](#).



Charles Sapp turned a walnut handle for a vintage ice cream scoop (aka garage sale item vs kit) and a streptohedron. It has rotational symmetry which when turned, split, and reglued creates a unique compound curve. Other shapes can be obtained by combining different axis of rotation.



At the "Broom Making Symposium" in Montgomery County, Dave Endres turned a broom handle (per specs) and used his home grown broom corn (sorghum) to make this broom. The sunset art work was styled after Nick Agar's turnings. One is in maple the other in hickory. An [anilyne dye](#) (soluble in alcohol or water) was used with an airbrush and gilding was applied to the high points of the textured areas.



Michael Blankenship (with some assistance from Jackie) discussed how he turned these segmented bowls. The jig allows him to get the correct angle of the segments on his table saw (he adjusts the angle until the pieces fit snugly in between the slats) and spacing. The first bowl has 12 segments and the second 16 segments. They are finished with 3 coats of Teak oil.



Ernie Guhl displayed doll house furniture that he has turned. They are from Corian, holly, ebony,....

Bill Farny turned these vessels. The first from walnut and the second from a combination of Corian and maple. Also note that Bill has his Kendama ready to go for the picnic in September. (Editor's note: It looked pristine so I don't think he has been practicing.)



Dan Burleson expanded his beaded skills to platters. An acid etch is used to create the design on the beaded plate.

Additional Entries for the President's Challenge – August Turning Thin



Gale Elbe turned this thin walled cherry bowl.



Big leaf maple burl bowl turned by Bob Goulding.



Natural edge calabash style (round bottom) bowl in catalpa by Charles Sapp.

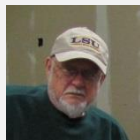

Spalted maple bowl by Ray Koeneman.



Laura Spelbring turned this bowl.



Bill Farny turned silver maple and honey locus bowls and a 36" thin spindle. The pictures show the string steady rest used by Bill when turning the spindle. It should make for an interesting Christmas ornament!



Thin walled cherry bowl by Jon Spelbring.

Woodturners of STL
771 Meadow Cliff Drive
St. Charles, MO 63303

Facebook site • Check out the club Facebook page:

<https://www.facebook.com/pages/Woodturners-of-St-Louis/292734664135601> and “Like” the page (click on the “Like” icon) to receive updates.



Board Members

President:	Jon Spelbring	618.698.3626	jon@spelbring.net
Vice President:	Dan Burleson	636.299.6302	danburleson1@gmail.com
Secretary:	Charles Sapp	636.928.0149	cwsapp@charter.net
Treasurer:	Walt Ahlgrim	314.567.5268	stlwoodturner@sbcglobal.net
Conf. Admin.	James Payne		jpayne.2011@gmail.com
Newsletter:	Charles Sapp	636.928.0149	cwsapp@charter.net
Librarian:	Rich Hinkebein	636.332.2396	kathryna1945@yahoo.com

Questions: info@stlturners.org